

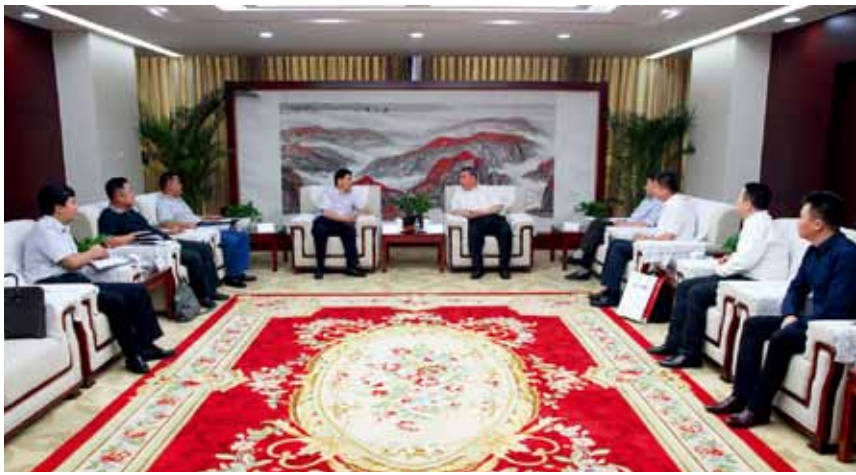

争做“三严三实”干部
推进集团改革发展



图片新闻



//

//

“ ”

5 28

“ ”

“ ”

“ ”

“ ”

“ ”

“ ”

“ ”

“ 6

Contents 目录

2015 6 93



1 “ ”

4 Avancis

5

6

7

8

媿媿

18

19

21 “ ”

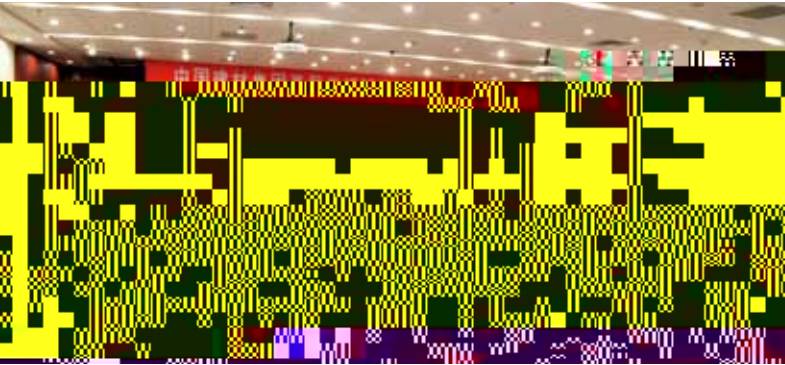
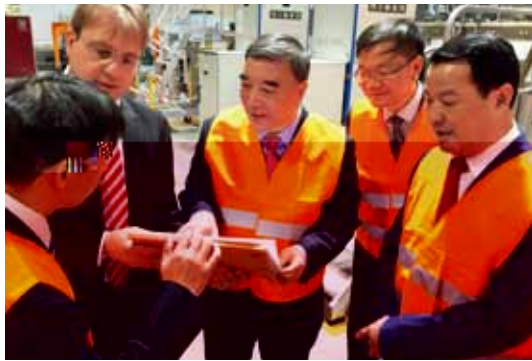

31

—

37

39

—

42

— 0 1

45

7

A

12

48

—

423

" "





Avancis

Avancis

Avancis



Avancis

Avancis

15GW

Avancis

6 9-11

Avancis
Avancis

TUV

Avancis

" +"

Avancis
CTF

Avancis

CEO FranzKarg CTOJorgPalm



“ ”

6 1

“ ”



8-12

112

140

12

6



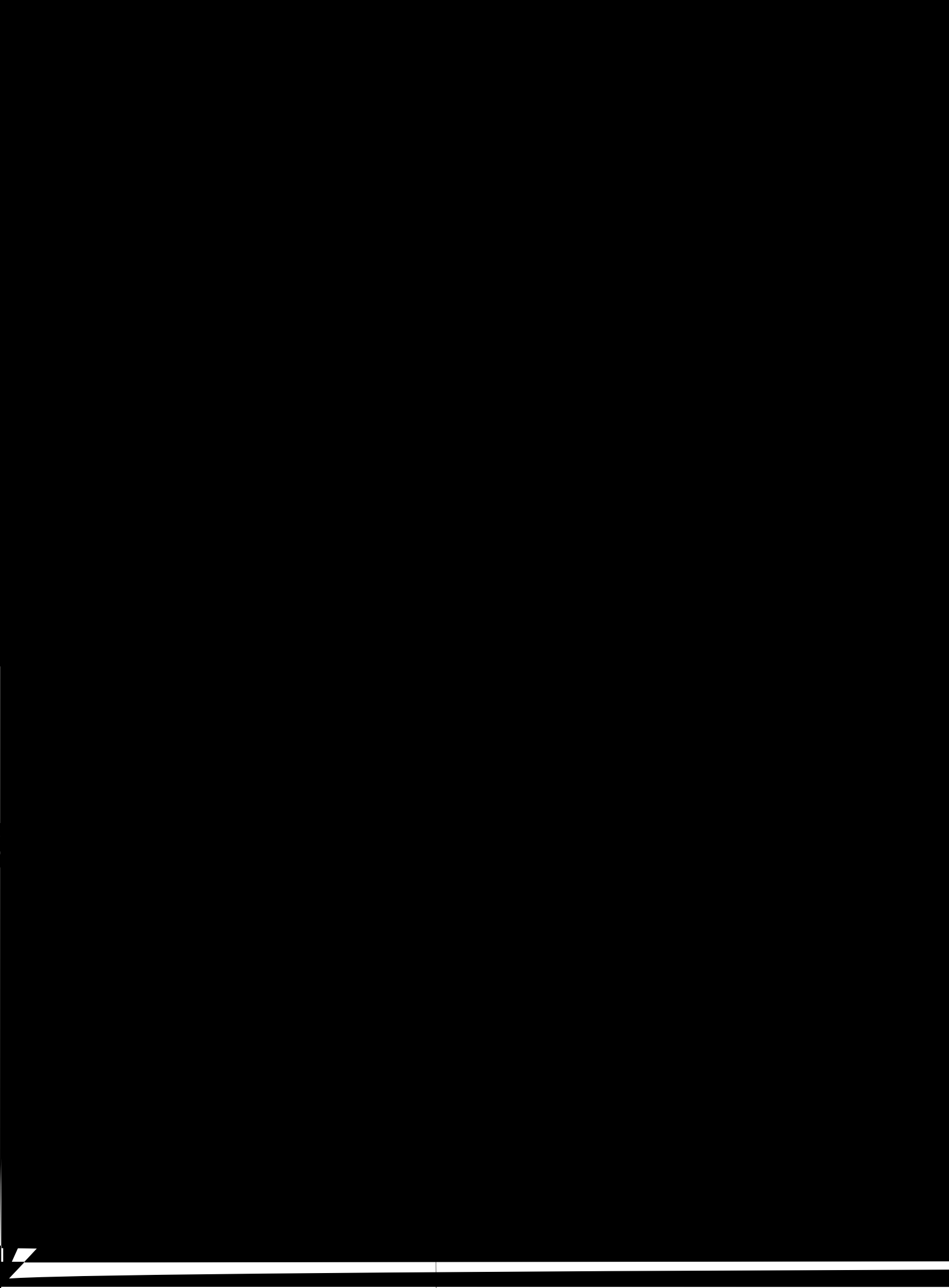

企业面临新挑战

“ ”
“ ” “ ” “ ”
“ ”
“ 4.0” “ 2025”

—

B2C
C2B O2O

“ ”

500



“ + ”

MADE IN CHINA
MADE IN PHILIPPINE

MADE IN BANGLA

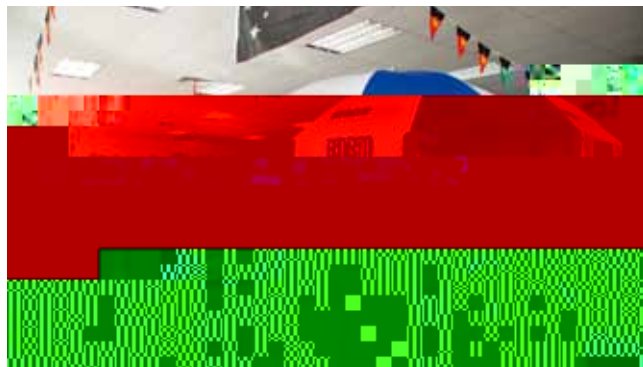

BNBMHOME

30%

" "

02

创新提升竞争力

" "

" "

" "

+

" " " "

1979

36

36

,

2000

“ ”

“ ”

“ ” “ ” “ ” “ ”

TFT

“ ”

“ ”

“ ” “ ” “ ” “ ”

“ ”

“ ”

“ ” “ ”

“ ”

"

2000

"

"

5000

10

T 700

6

2008

"

"

"

"

"

"

"

150

"

"

"

"

4000

600

100

"

500

"

2008

16%

60%

1153

85%

"

+

"

+

"

+

"

+

+

+

....."

IBM

1000

"

AGN

" "

" "

" "

" " " "

"

"

" " " "

" "

KPI

" "

" "

"

"

0 1

1 N

N 1



2 5 10

10

500

35

“ ”

2015 6 11

“

2015 6 14

.....



“

”

“

”

”

”

”

”

”

”

”

”

”

”

5 26



”

”

01

”

”

”

”

”

”

”

”



500 6 2 4 A " "

" "

18 " "

" "

" "

" "

“ ”

“ ”

“ ”

“ ” “ ”
“ ” “ ”
“ ”

“ ”

“ ”



“ ”

“ ”

“ ”

11

“

”

165

6



“ ”
” ”
” ”



03



“

”



“

”

”

”

“

”

2.

“

”

”

”

1.

3.

“

”

" " " " " "

“ ”

“ ”

1.

2.

90

3.

3.

"

"

"

"

6

17 " " 2012 4
[2012]167
" 2014
2015

10

--

10 22

13

700

5 WYC10 CCW-2008 2.2

 FA 6580 1640

 300kg/m³ 900kg/m³ 20.6

 2006

 2007

2 JC/T1062- 2006

 2007 " "

 " "

 1100kg/m³

 2005 Mb5.0 Mb7.5

 0.25W/m·K D25

- EPS

 3

 20%

-

40% 60%

" "

" "

90

1998

JC/T641- 2008

2006

2000

" "

"

GRC

JC/T945- 2005

" 2002

"

CCJJ/T135- 2009

"

3.

4

Low- E

JC/T940

"

"

Low- E

Low- E

5

2011

Low- E

35

Low- E

3000 m²

Low- E

Low-E Low-E
SZ 000786

标准隔墙

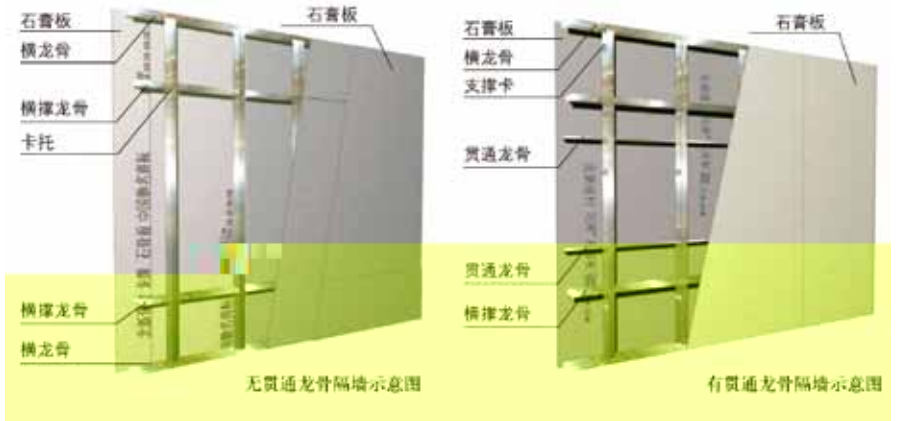

1

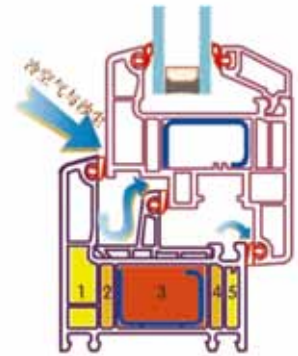

北新暖静门窗五腔室三密封结构图

1979
2000
2004
3000
2005
5000
2006
100
3000
20
54
16.5
65

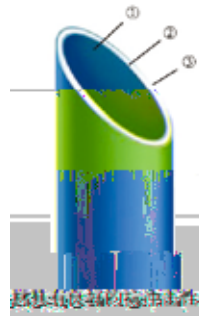

①光滑的内层具有优良的隔热性和耐化学腐蚀性。

②特制的中层采用粘弹性材料，起到隔音、减振和吸引可闻发声波的作用。

2

30



金邦板-K系列



金邦板-S系列

3

4.

1

45 53dB
1.5 4

" "

"

"

2

1 4

2.

1.

3.

3

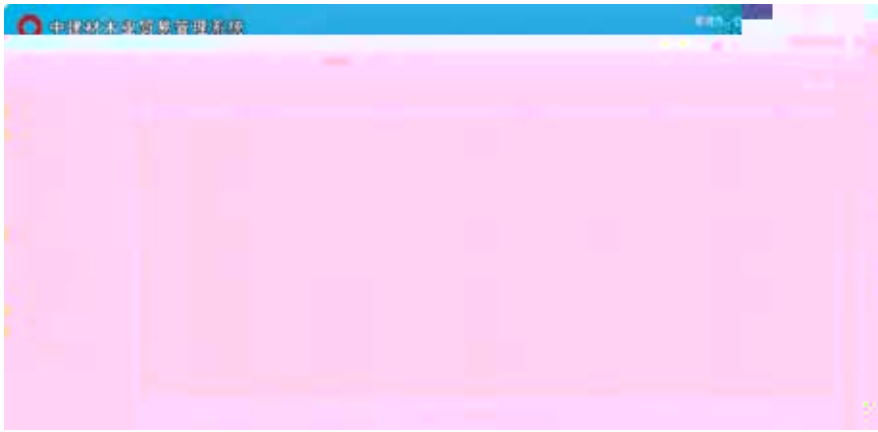

6.

100%

2.

ERP

3.

ERP

4.

1.

5.

“

”

500



“ ”

“ ”
“ ”

“ ”

“ ”

“ ”

“ ”

“ ”

“ ”

“ ”

“ ”

”

”



1.

1

“ ”

“ ”

“ ”

”

“ ”

”

“ ”

“ ”

”

“ ”

”

“ ”

“ ”

“ ”

“ ”

“ ”

“ ”

“ ”

2.

KPI

“ ”

1

“ ”

2

“ ”

“ ”

“ ”

“ ”

”

”

“ ”

“ ”

+

”





1 n

1 n

DMC

6000

5000

DMC

5700

1000

0 1

IBM

IBM

Google

0 1

“ ”

0 1

0 1

“ ”

19



1999

0 1



->

->

15

10

Twitter LinkedIn

Google

N

“ Don't be evil()”

5

Google



2

Google

“ Don't be evil”

CC copy to China

“ ”

.

.

.

- 1.
- 2.
- 3.
- 4.
- 5.
- 6.
- 7.

10 20

Stay Hungry. Stay Fodish
0 1

4.0

4.0

2012

EPC

4.0

2013

0 1

0 1

CNBM

CNBM

1 n

0 1

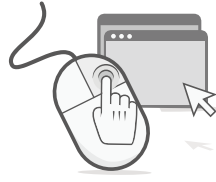

01

7

A

6 23

" 2014

A

",

41

A

7

A

2014

130

13%

2504

" "

" "

" "

02

6 19



03

" 2014

"

" 2014

"

160

48

28 6 14

6

" "

04

"

6 1

"

" "

"

"

" "

"

2014

89

"

"

6

05

2015

2015 1~4



2015 KPI

06

"

"

"

"

"

"

"

LDHs

"

07

26

26

0.2

Fabiano Nicoletti

08

CTC

ISO

2015

CTC

ISO 18558

ISO

CTC 2011

2013

ISO

ISO

40

09

CTC

CTC

"

X

MLD

" " X

MLD

"

CTC

12

10

6 3

6 4

"

"

"

"

11

2015

"

"

6 10~12

让信仰点亮人生



中国建材集团

开展丰富多彩的

喜迎七一活动



1.
2.
3.
4.

“ ”
“ ”
“ ”

94

5.
6.
7.
8.

“ ”
“ ”

